

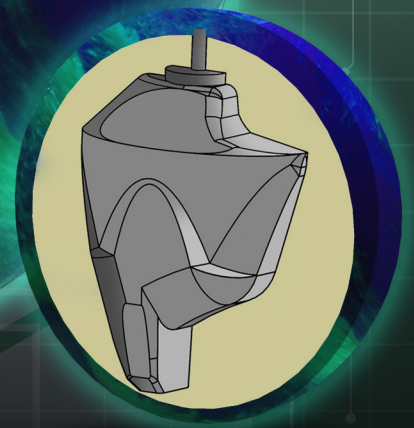

SIMPLY DEVASTATING™



## PHOTON™ LMB

The PHOTON line is a new line in the Seismic arsenal to use the popular HORN Core, our fast revving Asymmetric core from the BULL series.

The PHOTON LMB (Low Mass Bias) contains a modified version of the HORN Core, with a reduced Differential and Mass Bias, allowing you to achieve easier length through the heads and midlane with more angularity on the back end.

The Photon LMB combines the best aspects of both symmetric and asymmetric core balls.

Get scientific with your arsenal - add the PHOTON.

LINE / CORE HORN™ CORE

COVERSTOCK S.F-8/8™ PEARL REACTIVE

FACTORY FINISH POLISHED

COLOR AQUAMARINE / ROYAL

POWER RATING 225

	14lb	15lb	16lb
RADIUS OF GYRATION	2.590	2.580	2.570
DIFFERENTIAL	0.030	0.030	0.031
MB DIFFERENTIAL	0.011	0.011	0.011

# HORN CORE

SEISMIC BOWLING LTD - FOR MORE INFORMATION VISIT YOUR LOCAL PRO SHOP OR [WWW.SEISMICBOWLING.COM](http://WWW.SEISMICBOWLING.COM)

